

Discontinuing an Infusor™ from an Implanted Venous Access Device (IVAD)

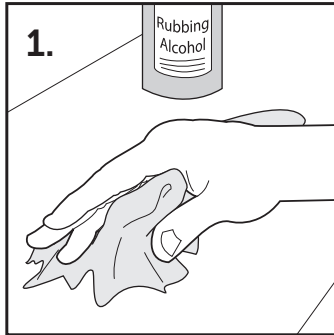

1. Clean working surface with rubbing alcohol.

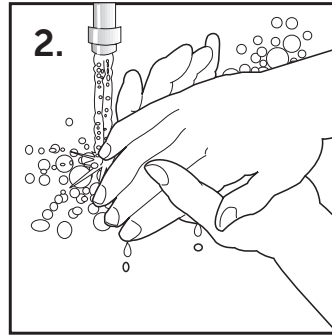

2. Wash hands and dry with clean towel.

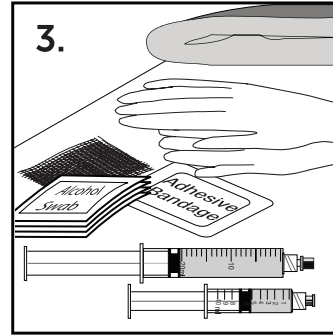

3. Gather equipment & place on clean surface:

- Gloves
- Alcohol swabs
- Gauze

*Your nurse will inform you if your IVAD requires heparin.

*If your line does not require heparin, skip steps 11 and 12

- Adhesive bandage
- 20ml normal saline syringe
- Heparin*

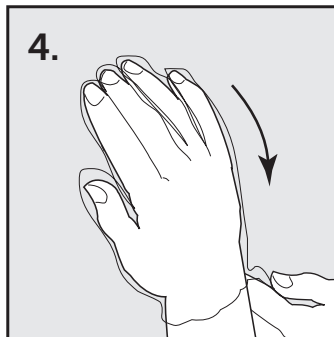

4. Put on gloves.

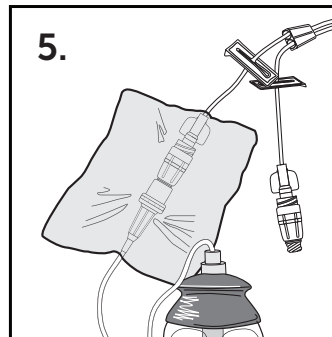

5. Slide clamp of line connected to the infusor to the closed position.

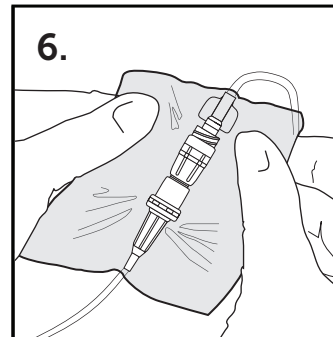

6. Remove the tape that holds white sensor against skin.

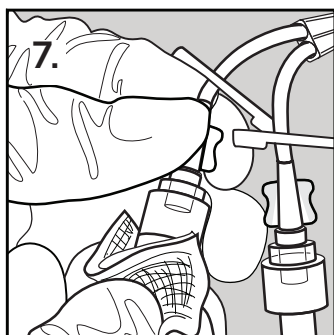

7. Scrub the cap of the line that is not connected to the infusor pump. Allow cap to dry.

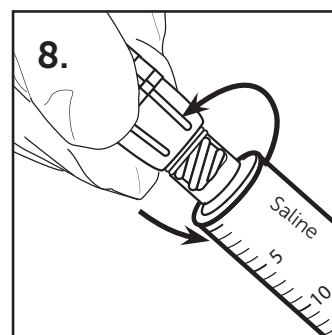

8. Connect the syringe of saline to the clean cap by twisting the syringe clockwise.

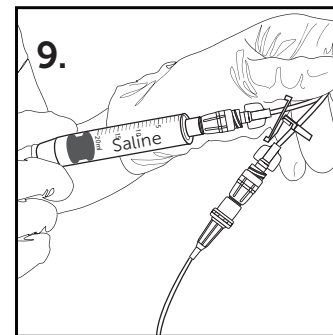

9. Open slide clamp and push 20 mLs saline using a start-stop motion. While pushing, clamp the line when 1 ml saline left.

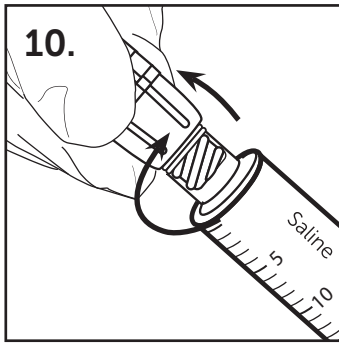

Remove syringe by twisting syringe counter clockwise and place in Cytotoxic waste container.

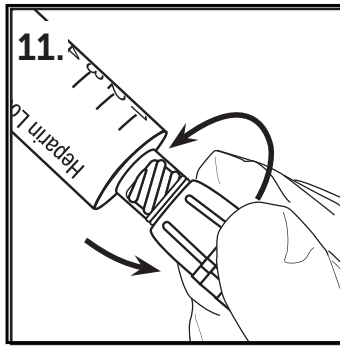

If heparin is required for your line connect the heparin syringe by twisting the syringe clockwise.

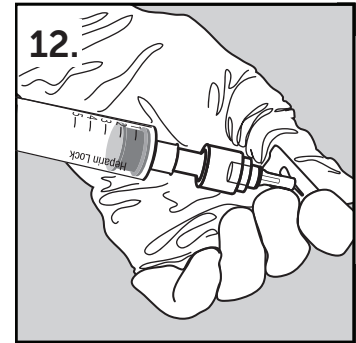

Open slider clamp. Slowly push heparin into the tubing. When the syringe is almost empty, clamp the line.

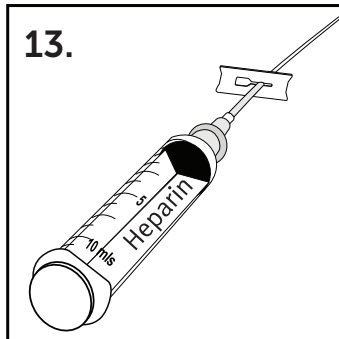

Leave syringe attached and tubing clamped.

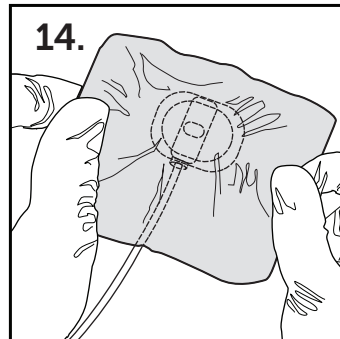

Stabilize the IVAD and remove the old dressing and discard into the cytotoxic waste container.

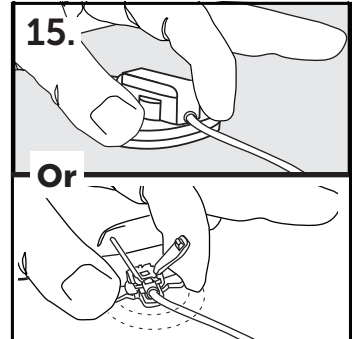

Once the tape is removed, stabilize the IVAD with your non-dominant hand.

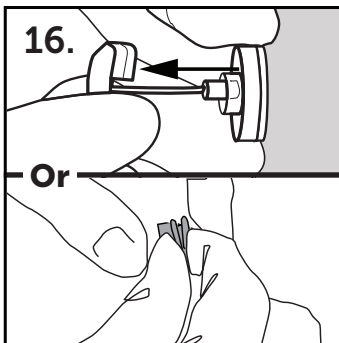

While stabilizing the needle device against the skin, pull needle straight out.

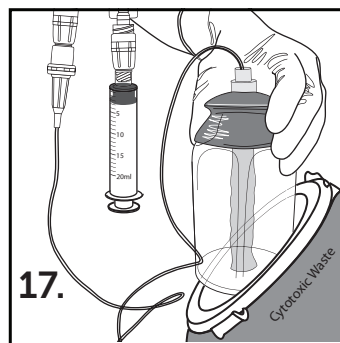

Place Infusor™ and used supplies in the Cytotoxic Waste container.

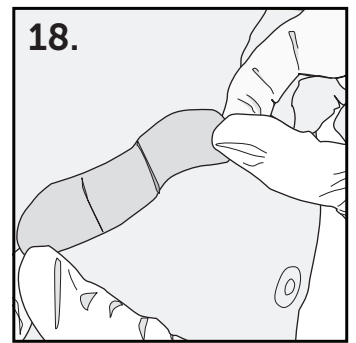

Put a Band-Aid over the needle site.

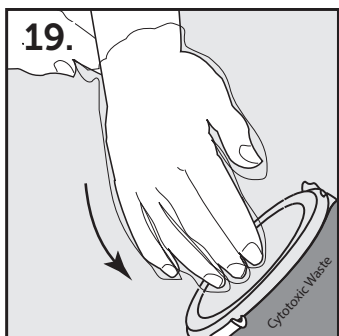

Take off gloves and discard in cytotoxic waste container.

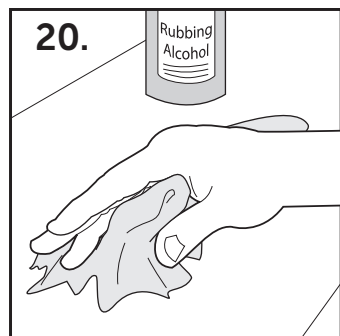

Clean working surface with rubbing alcohol.

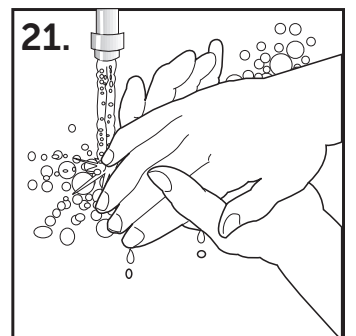

Wash hands and dry with clean towel.